



Heat Transfer Material for Textiles

PRINT & CUT

HEAT TRANSFER FLEX & FLOCK FILMS

TATOO | ClearFlex

PVC Free! 100% Polyurethane Construction

- Excellent Color Retention
- Bright White for Brilliant Images
- Light & Stretchable
- High Resistance to Washing
- Very User Friendly Print & Cut

Tattoo, White Tattoo is our premium and most popular opaque polyurethane film. Suitable for eco-solvent, solvent and latex printing. Known for being super thin & stretchable.

Tattoo Nylon, White Tattoo Nylon is specially formulated for nylons and coated materials. The multi-layer design of Tattoo Nylon contains a hot melt adhesive that was developed especially for adhering to water resistant textiles. We recommend testing prior to full production to ensure proper adhesion.

Tattoo SBB, White Tattoo SBB was formulated with a proprietary (Sublimation Blocking Barrier) layered to prevent sublimated and or dyed polyester inks from migrating through to the first surface. Tattoo SBB has the same color retention and washing resistance, consistent to our line of Tattoo heat transfer products.

Tattoo Pearl, White Tattoo Pearl's unique finish provides for a pearl essence sheen when printed with eco-solvent, solvent and or latex inks. Pearl's unique construction also allows for excellent color fastness, stretch and washing resistance.

ClearFlex For White or Light Colored Fabrics The ultimate clear super thin transparent polyurethane flex film! Once printed and applied, ClearFlex almost feels like a screen printed image. ClearFlex's unique construction allows for the printed image to be sandwiched between the fabric and the polyurethane film. This helps preserve the image color fastness through washing and exposure to the elements.

- No transfer tape required
- Print with eco-solvent, solvent & latex inks
- Super thin for excellent stretch
- Encapsulated image for total protection
- Print in reverse / mirror image

Note: Application of all Tattoo products requires our specially formulated **FlexTape** (a heat stable semi-clear polyester transfer tape) to assist in the application process for textile material. Please refer to our application instruction sheet for transfer settings / recommendations.

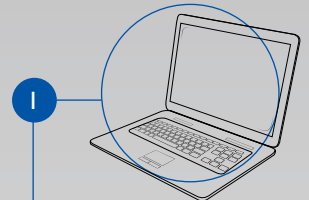

1 Scan or create a digital vector image.

SPECIAL NOTE

For ClearFlex, print a mirror-image of your design.

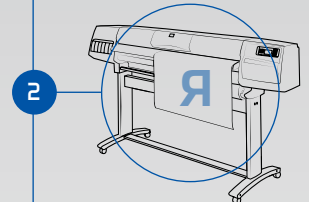

2 Print on our material with an ink jet printer.

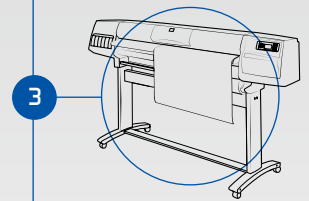

3 Insert the printed film into a cutting-plotter and cut according to the outlines.

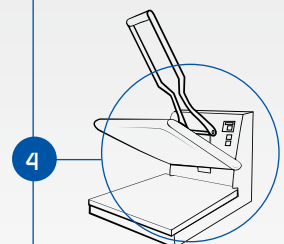

4 See application guide for specific instructions for SEF films.

